

UNIT DETAILS (FOR SELL)

BLOCK 26 TO 32

BLOCK TYPE -A

TOTAL NO OF BLOCK = 3
 TOTAL NO OF FLAT = 16 (EACH BICK)
 TOTAL NO OF FLAT = 16X3 = 48 NOS.
 TOTAL BUILT UP AREA = 48X26.849
 = 1288.752 SQ.M.

BLOCK TYPE -B

TOTAL NO OF BLOCK = 4
 TOTAL NO OF FLAT = 16 (EACH BICK)
 TOTAL NO OF FLAT = 16X4 = 64 NOS.
 TOTAL BUILT UP AREA = 64X33.63
 = 2,152.32 SQ.M.

TOTAL NO OF FLAT = 48+64 = 112 NOS.

TOTAL BUILT-UP AREA = 1288.752+2,152.32
 = 3,441.072 SQ.M.

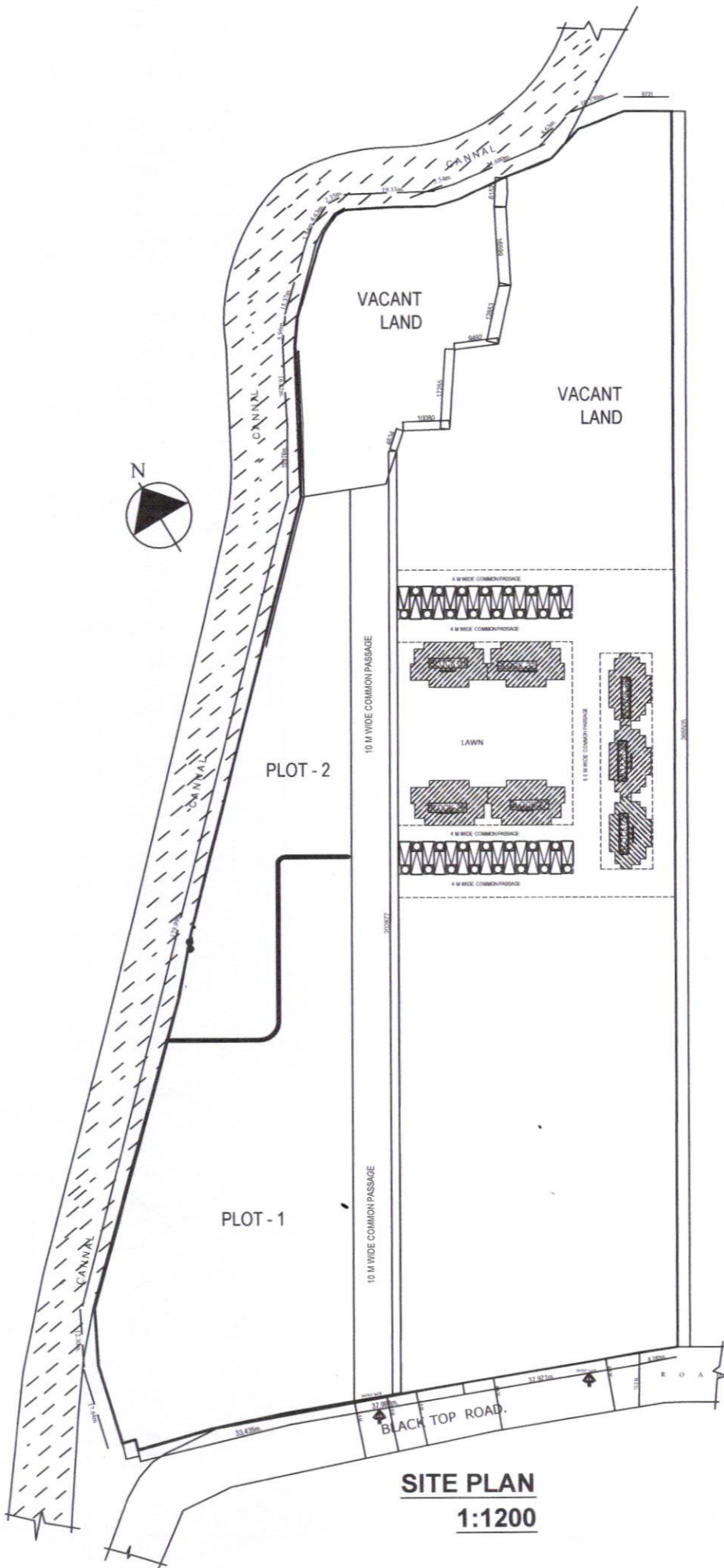

For Sree Balaji

 Proprietor

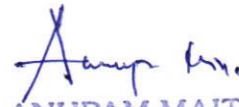
SIGNATURE OF OWNER

ANUPAM MAITI
 C.O.A. Registered Architect
 CA/2010/48538
 anupam.mozaik@yahoo.co.in

SIGNATURE OF ARCHITECT

For Sree Balaji

 Proprietor

SIGNATURE OF BUILDER

LAND OWNER SREE BALAJI AT MOUZA-DAKSHIN DHUPIHORA,
 L.R. PLOT NO.-537, 539, 540(P), 541(P), 542(P), 543(P), 544(P)& 545(P).
 TOTAL LAND AREA =3.316 ACRE - 143283 SQ.FT. i.e. 13311.307 SQ.M.

J.L. NO - 28 , L.R. KHATIAN NO - 1203.

DISTRICT - JALPAIGURI, POLICE STATION-MATIALL, POST
 OFFICE- BATABARI, PIN - 735206.